

# PRODUCT DATA SHEET

## FULLY INSULATED FEMALE DISCONNECTS



### DESCRIPTION

Fully Insulated Female Disconnects maintain low insertion force, high retention to easily mate with male nails. It can prevent the wire from short circuiting, provides perfect connection for the wire.

### FEATURES

- Standard : DIN 46237
- Material : Brass, Tin Plating
- Insulation : PVC
- Operating Temperature : Maximum From 75° to 600 Volts

### MARKINGS



- It complies with RoHS standards.
- It complies with UKAS Quality Management standards.
- It complies with CE standards.
- It complies with UL standards.

# PRODUCT DATA SHEET

## FULLY INSULATED FEMALE DISCONNECTS

### SECTIONS AND DIMENSIONS

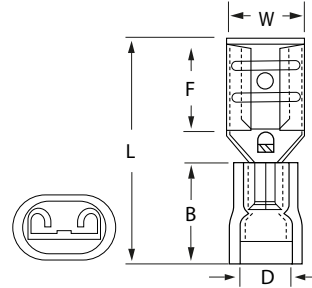

PRODUCT CODE	COLOUR	CABLE SECTION (mm <sup>2</sup> )	SOCKET WIDTH	DIMENSIONS (mm)				
				W	F	L	B	D
GFFD - 1288	Red	0.50 - 1.50 mm <sup>2</sup>	0.8 x 2.80	3.2	6.5	19.0	10.5	3.8
GFFD - 1488	Red		0.8 x 4.75	5.0	6.4	20.5	10.5	3.8
GFFD - 1638	Red		0.8 x 6.35	6.6	7.5	21.8	10.5	3.8
GFFD - 2288	Blue	1.50 - 2.50 mm <sup>2</sup>	0.8 x 2.80	3.2	6.5	20.0	10.5	4.7
GFFD - 2488	Blue		0.8 x 4.75	5.0	6.4	20.2	10.5	4.7
GFFD - 2638	Blue		0.8 x 6.35	6.6	7.5	22.2	10.5	4.7
GFFD - 5638	Yellow	4.00 - 6.00 mm <sup>2</sup>	0.8 x 6.35	6.6	7.5	24.2	12.5	6.2